

REVISIONS			
REV.	DESCRIPTION	DATE	APPROVED
0	Initial Draft	3/24/2017	

NOTES

 see "ROX InGaAs Photoreceiver Datasheet and User Manual" for detailed APD positioning

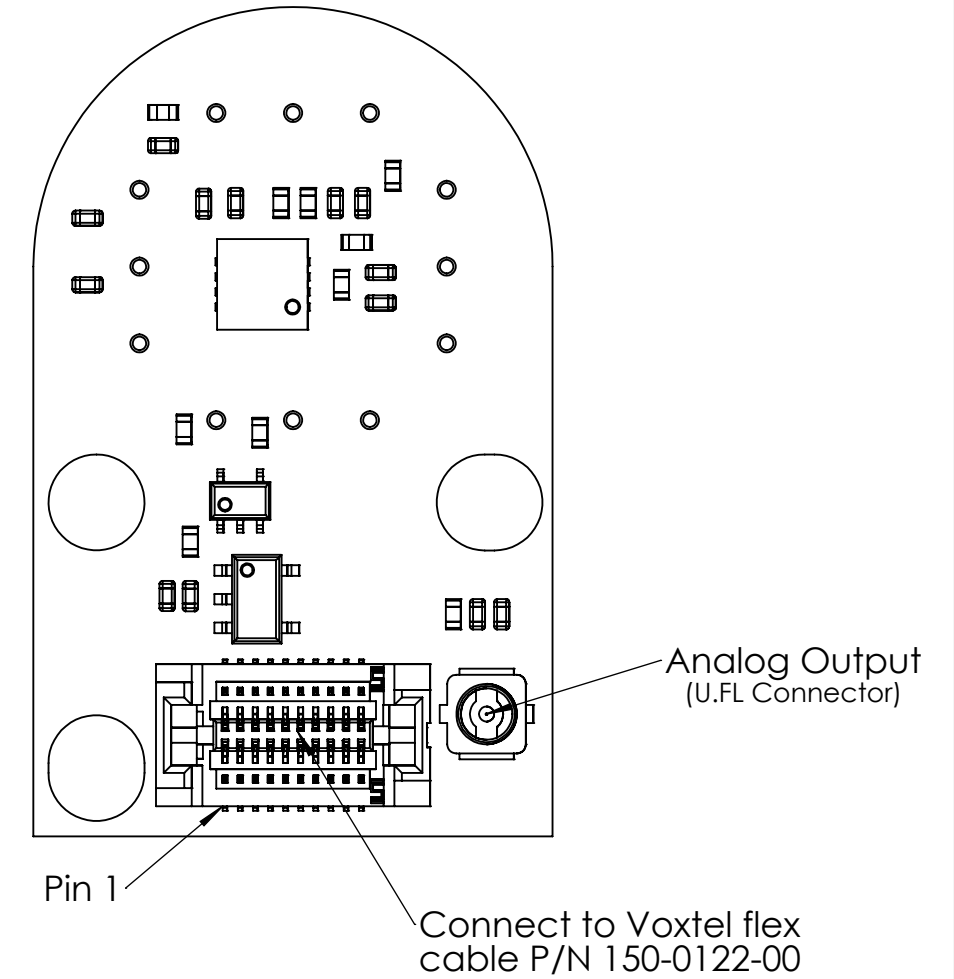
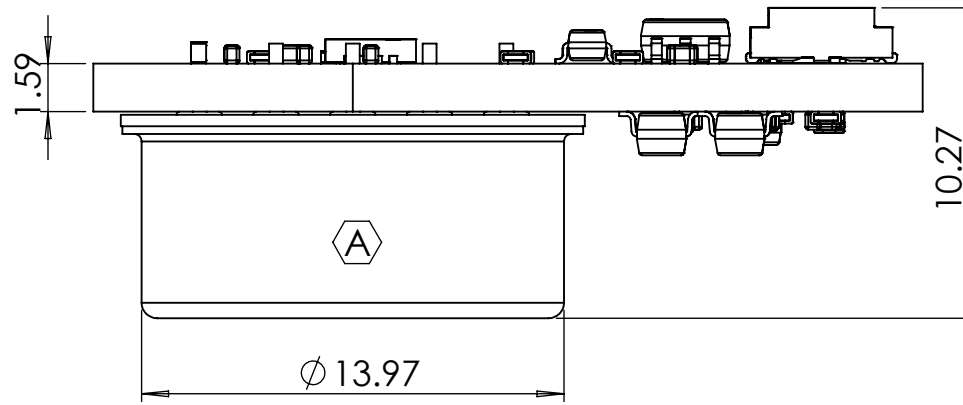
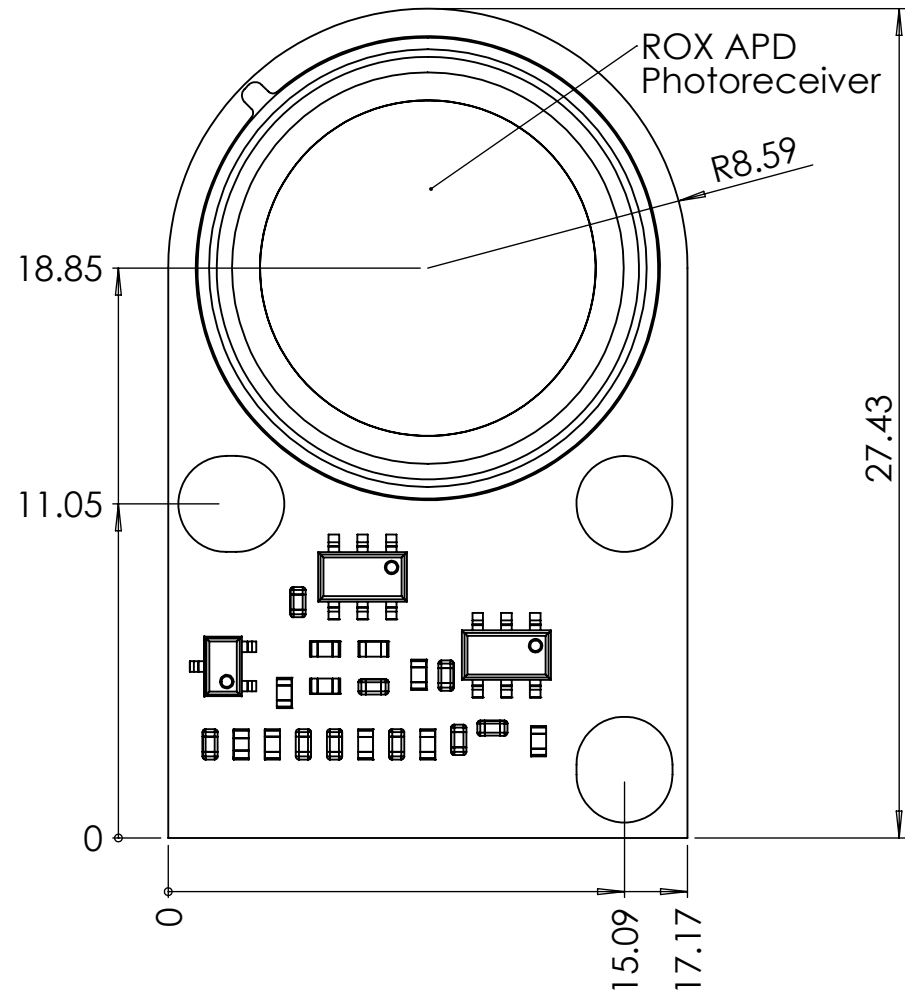

ROX APD Photoreceiver Interface		
Pin	Name	Description
1	VAPD	High voltage APD bias
2, 4, 10, 14	GND	Digital ground
3, 12	NC	No Connection
5, 7, 17	AGND	Analog ground
6	SIG-	Negative differential ROX output
8	SIG+	Positive differential ROX output
9	+3.3V	3.3V digital supply
11	VTHSW	3.3V logic signal for switching between VTHH and VTHL
13	VTHL	Threshold low voltage
15	VTHH	Threshold high voltage
16	uCLK	ROX i2c clock
18	uDATA	ROX i2c data
19	VCMOS2	5V input power to ROX
20	START	ROX mode control input

PROPRIETARY AND CONFIDENTIAL
 THE INFORMATION CONTAINED IN THIS DRAWING IS THE SOLE PROPERTY OF VOXTEL INC. ANY REPRODUCTION IN PART OR AS A WHOLE WITHOUT THE WRITTEN PERMISSION OF VOXTEL INC IS PROHIBITED.

UNLESS OTHERWISE SPECIFIED: DIMENSIONS ARE IN MM	NAME	DATE	VOXTEL INC TITLE: APD Photoreceiver PCBA ICD
	DRAWN	D. Miller 3/14/2017	
	CHECKED		
	ENG APPR.		
INTERPRET GEOMETRIC TOLERANCING PER:	MFG APPR.		SIZE DWG. NO. REV B 150-0121 00
MATERIAL	Q.A.		
FR-4	COMMENTS:		
FINISH	DO NOT SCALE DRAWING		SCALE: 4:1 WEIGHT: 5.5 g SHEET 1 OF 1